

# Saw benches with great stability for industrial and agricultural use!

- Widia saw blade with 90 teeth: 750 dia. for 30 dia. hole included.
- Cutting control with standard thrust (ST).
- Hydraulic cutting control optional (ID). Code 851.042.K.
- Transmission with low friction XPA belts.
- Stable transport grip removable: included for all models.
- 3-point connector 1<sup>st</sup> – 2<sup>nd</sup> cat. for all models.
- All versions can be coupled with a 4 m x 0.25 or a 5 m x 0.25 conveyor belt.

**OPTIONAL: Code 851.035.K** Exclusive safety system. NOT for the ECO model.

### NEXA-System... its usefulness

- Extremely simple and safe!
- With the open swing tank the device disappears from the working area.
- During the cutting phase it does not create any hindrance!
- When the cutting phase is completed it positions itself automatically and hinders the feeding of logs with uncovered blade!

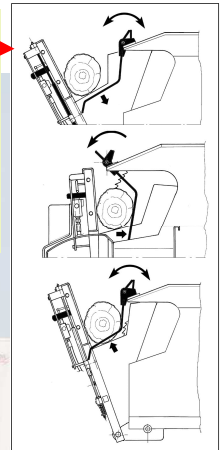

Cut adjuster and discharge conveyor as standard (already pre-set for conveyor belt).

**OPTIONAL: For ECO model - Code 851.121.K**

Side feed mounted on bearings, with vertical stop position for transport.

Full transport wheels 400 dia. as standard.

**OPTIONAL: Code 200.193.K**  
Pneumatic wheels 400 dia.

Self-lubricating bushings mounted on the fulcrum of the swing tank.

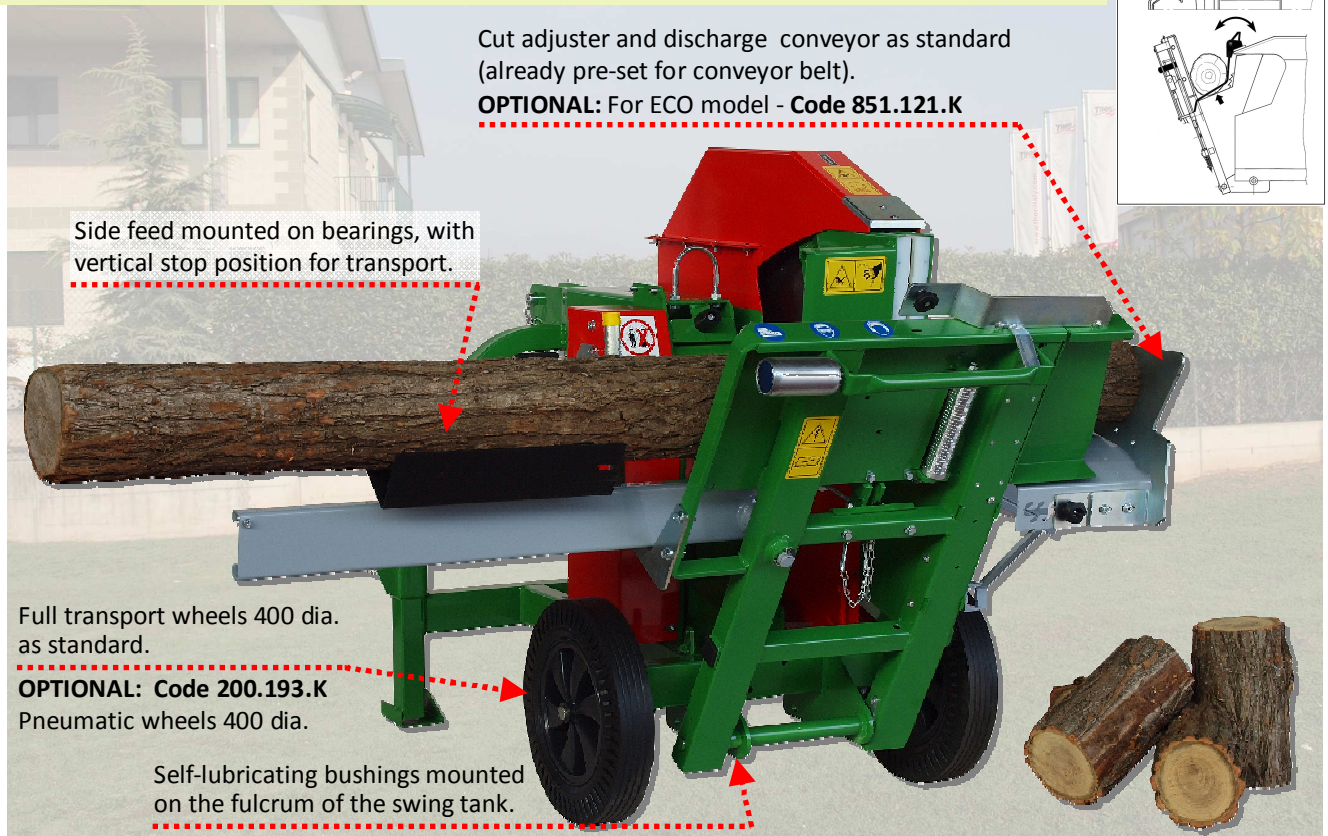

**OPTIONAL: Code 600.125**  
Cardan shaft with safety bolt.

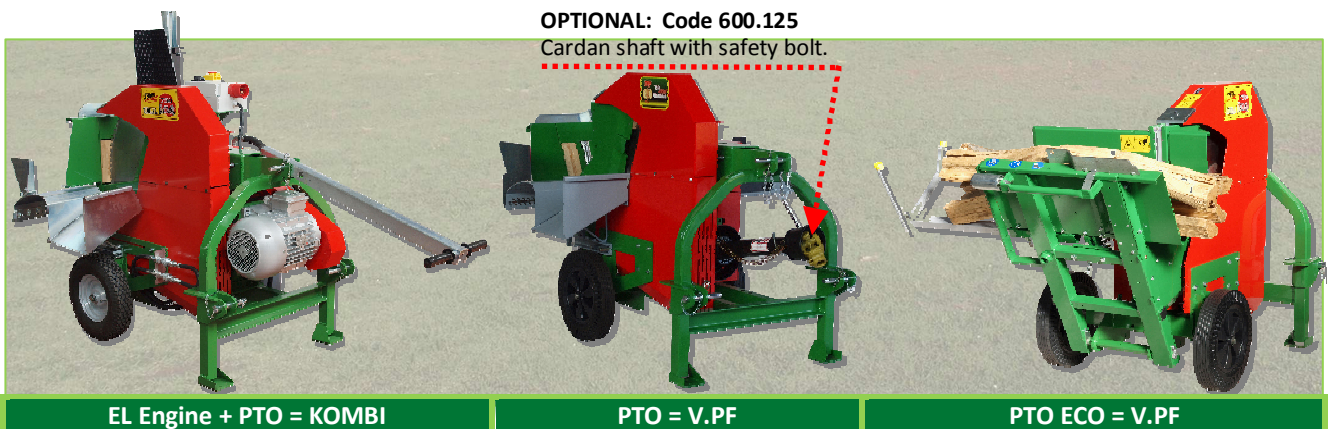

EL Engine + PTO = KOMBI

PTO = V.PF

PTO ECO = V.PF

# SWING TANK SAW BENCH for max. $\varnothing$ 30 cm dia. cut



Simple swing tank and discharge conveyor for ECO model.



Model 750 ECO

Discharge, suitable for conveyor belt or Tandem.

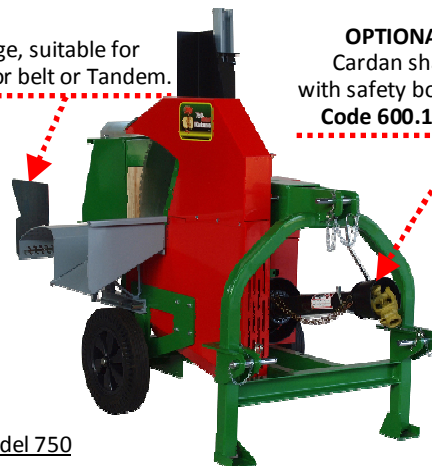

Model 750

OPTIONAL:  
Cardan shaft with safety bolt.  
Code 600.125

OPTIONAL:

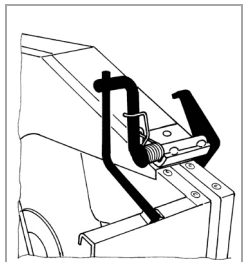

Safety device  
NEXA-System

Code

851.035.K

Series with STANDARD controls	Katana 750 ECO	Katana 750	Katana 750	Katana 750
<b>Widia blade</b> 750 mm dia. for 30 dia. hole (mm) <u>included</u>	$\varnothing$ 750 - DW.750.30	$\varnothing$ 750 - DW.750.30	$\varnothing$ 750 - DW.750.30	$\varnothing$ 750 - DW.750.30
Power supply <b>V.PF</b> = tractor, <b>EL</b> = electric, <b>Kombi</b> = electric motor + tractor	<b>V.PF</b> 540 rpm	<b>V.PF</b> 540 rpm	<b>EL</b> 400 Volt	<b>Kombi</b> (EL 400 V + V.PF)
Power required (HP / kW)	25 / 18	25 / 18	12 / 9	7.5/5.5 – 25/18
Hydraulic control (ID)	optional 851.042.K	optional 851.042.K	optional 851.042.K	optional 851.042.K
Max. dia. cut (cm)	30	30	30	30
Blade revs (rpm.)	1400	1400	1400	1400
Blade stopping brake	<input type="checkbox"/>	<input type="checkbox"/>	<input checked="" type="checkbox"/>	<input type="checkbox"/> / <input checked="" type="checkbox"/>
3-point connector 1 <sup>st</sup> – 2 <sup>nd</sup> cat.	<input checked="" type="checkbox"/>	<input checked="" type="checkbox"/>	<input checked="" type="checkbox"/>	<input checked="" type="checkbox"/>
Transport wheels (mm dia.) <i>full</i>	400	400	400	400
Thrust roller 60 dia. x 120 <i>for ST version</i>	optional D.60.120	<input checked="" type="checkbox"/>	<input checked="" type="checkbox"/>	<input checked="" type="checkbox"/>
Cut adjuster and discharge conveyor for conveyor belt	optional 851.121.K	<input checked="" type="checkbox"/>	<input checked="" type="checkbox"/>	<input checked="" type="checkbox"/>
Side folding logs feed	<input type="checkbox"/>	<input checked="" type="checkbox"/>	<input checked="" type="checkbox"/>	<input checked="" type="checkbox"/>
<b>"NEXA-System"</b> (Safety)	<input type="checkbox"/>	optional 851.035.K	optional 851.035.K	optional 851.035.K
Cardan shaft for transmission with safety bolt	optional 600.125	optional 600.125	<input type="checkbox"/>	optional 600.125
Weight (kg)	210	225	310	285
Shipment dimensions (AxBxH cm)	80x120x130	80x120x160	80x130x160	80x120x160
<b>List price excl. VAT (€)</b>				
Net price excl. VAT (€)				
★ = delivery time: 4 weeks	★		★	★
<b>Code</b>	<b>705.B.V.PF/ST.W</b>	<b>705.V.PF/ST.W</b>	<b>705.3812/ST.W</b>	<b>705.388.K/ST.W</b>

= NO     = YES

OPTIONAL ACCESSORIES						
Description	Steel blade	Widia blade	Hydraulic control (ID)	Cardan shaft with safety bolt	Pneumatic wheels 400 dia.	Discharge for conveyor
	all models	all models	all models	all models	all models	Katana 750 ECO
Code	DA.750.30	DW.750.30	851.042.K	600.125	200.193.K	851.121.K